

## TYXIA 1712

**EN** Group remote control



## Technical characteristics

- Power supplied by 3V lithium battery, CR2430
- Class III insulation
- X3D Transmission frequency:  
868.7 MHz to 869.2 MHz
- Maximum radio power < 10 mW
- Receiver category II
- Wireless range: 100 to 300 metres outside,  
variable depending on the associated equipment  
(the range can vary depending on the installation  
conditions and the electromagnetic environment)
- Mounted on a base
- Dimensions: 46 x 121 x 10.7 mm
- Degree of protection: IP 40
- Operating temperature: 0 to +55°C
- Storage temperature: -10 to +70°C
- Installation in an environment with normal  
pollution levels

## Content

1/ Location/Mounting	4
1.1 Mounted on the wall	4
1.2 Placed on a flat surface	5
2/ Wireless association	6
3/ Create a group	9
4/ Use	10
5/ Troubleshooting	11

## 1/ Location/Mounting

### 1.1 Mounted on the wall

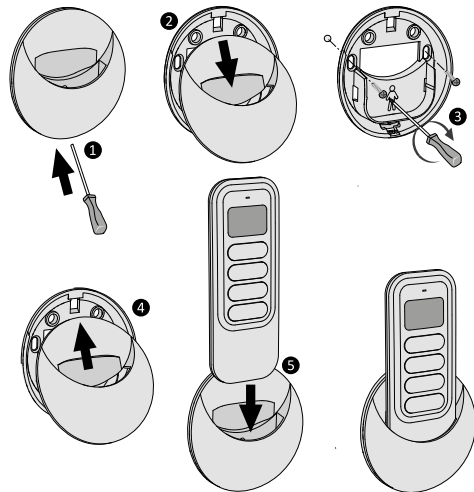



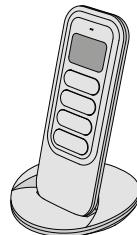

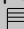

### 1.2 Placed on a flat surface

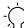
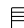

## 2/ Wireless association

This chapter allows you to associate with one or more X3D wireless motor(s), roller shutter receiver(s) or lighting receiver(s). You can associate up to 16 receivers (or motors) per activity  or .

- 1 Set all the motors or receivers in the same "activity" ( or ) to association standby mode.
- 2 Select the desired "activity" by pressing  or .
- 3 On the remote control press  and  at the same time and hold for 3 seconds, until the LED flashes. Release.
- 4 After a few seconds, the roller shutters (or lights) turn on briefly when they are associated. The number of associated items (shutters or lights) is displayed on the screen ()

The association mode is automatically exited when the screen displays .

### 1 Activating association standby mode

#### - Motor:





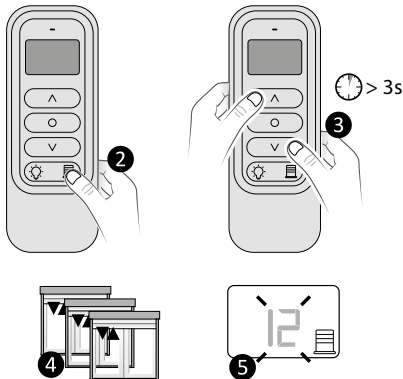

- 1) Upon turning on for the first time, if the motor was not associated before.
- 2) From a remote control used for the motor (already associated) press the  button for 3 seconds.

- **Receiver:** press its button for 3 seconds until the LED flashes.

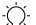

### 3/ Create a group





Creating a group allows the simultaneous control of multiple receivers (or motors).

- 1 Select the desired "Activity" by pressing  or  for three seconds until the  symbol flashes. Release.
- 2 Press  or  as many times as required to select the number of the group to create (e.g. 9).
- 3 Select the receiver (or motor) by pressing on  as many times as required. The controlled item is activated briefly (roller shutter or lighting).
- 4 Press  to add a group to it. The screen displays "IN".  
or press  to remove it from the group. The screen displays "OUT".

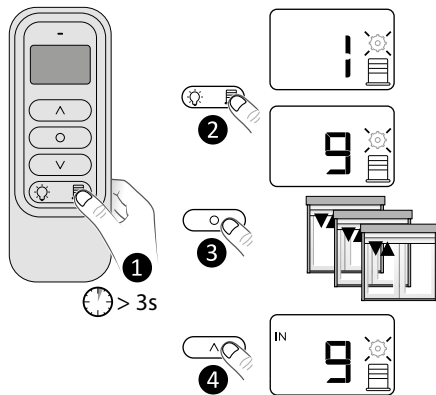
Repeat stages 3 and 4 for each receiver (or motor).

To create another group, repeat stages 2, 3 and 4.



- You can create up to 16 groups per "activity"  or .
- A single receiver can be associated with multiple groups.
- To exit the mode press  or  for 3 seconds.

## 4/ Use

- 1 Select the desired "Activity" by briefly pressing

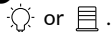

- 2 Press or as many times as required to select the number of the group to control:

- ... : Groups 1 to 16

- :: Group Total

- 3 Press , or to control the light(s) or roller shutter(s).  
The LED changes from red to green if the receiver has correctly received the information.

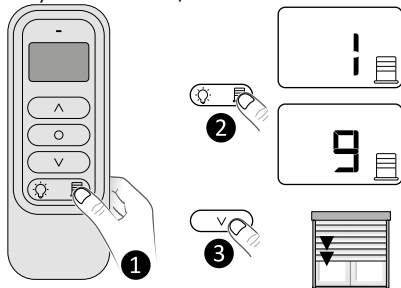

## 5/ Troubleshooting

- The screen displays .

The battery is low. Change the battery.



EN

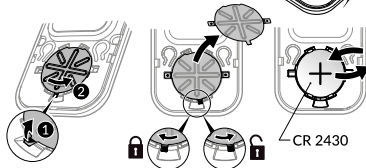

- Remove an association

- Remove the front face of the remote control.
- Press button A. The red LED flashes.
- Press as many times as required to select the motor (receiver) to remove.
- Press the button.
- Press button A to exit.

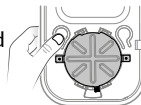

- Remove all associations

- Remove the front face of the remote control.
- Press button A. The red LED flashes.
- Press the and buttons at the same time and hold for 3 seconds.
- Press button A to exit.



[www.deltadore.com](http://www.deltadore.com)



2704633 Rev.03